

HORUS

MAISON FRANÇAISE DE ROBINETTERIE

EQUINOX 316



MAISON FRANÇAISE DE ROBINETTERIE

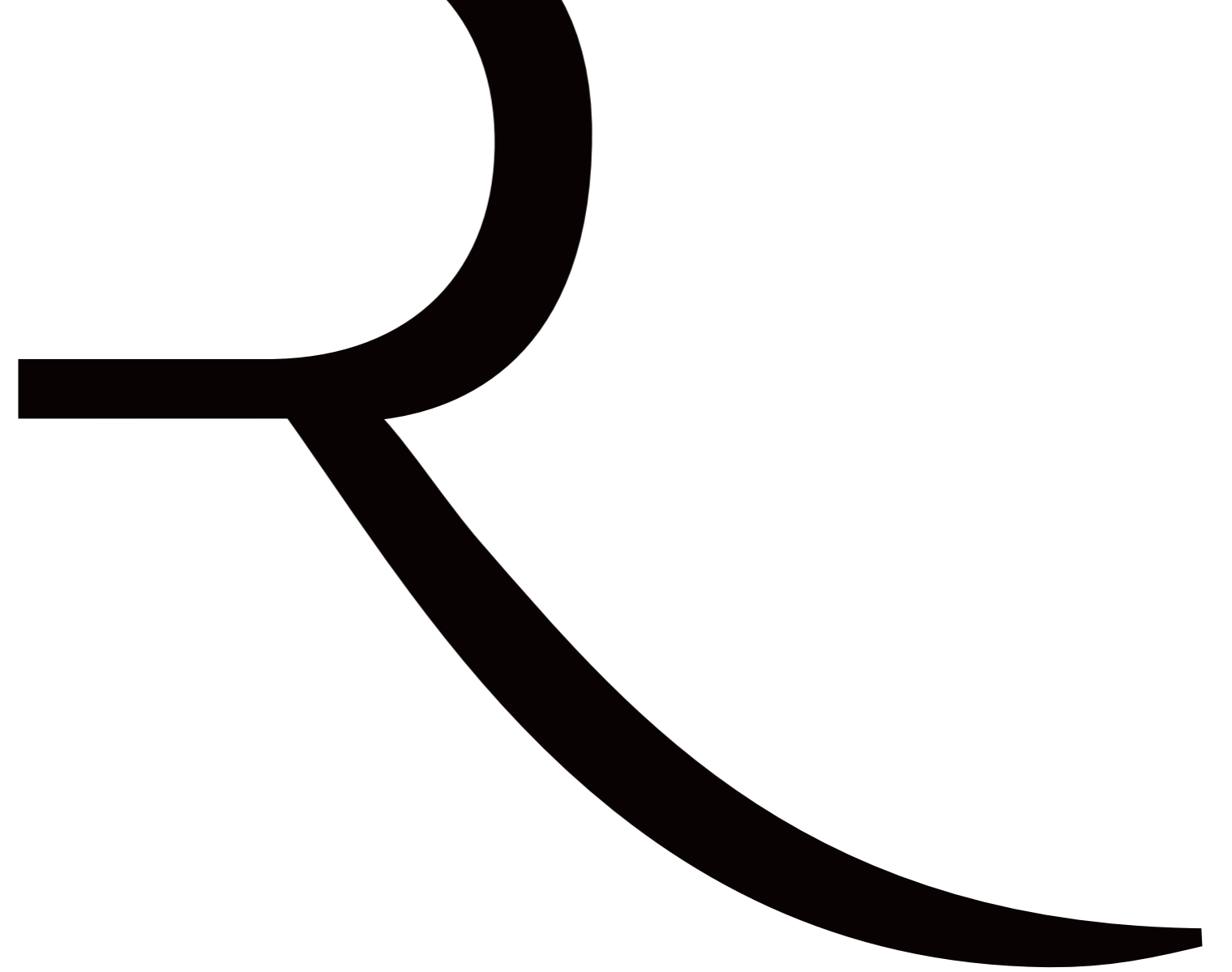





Horus a la particularité d'être à la fois une société artisanale et industrielle.

Disposant de son propre appareil de production, Horus contrôle l'ensemble de son processus de fabrication grâce notamment à son bureau d'études, de ses propres fonderies, d'un laboratoire hydraulique et acoustique interne.

Son côté artisanal repose quant à lui sur les mains expertes et expérimentées de ses employés qui depuis plus de 40 ans perpétuent le savoir-faire du luxe "haute couture" français.

Cette culture de l'excellence s'explique en partie grâce à la réalisation de robinetteries de luxe que notre société conçoit depuis sa création pour les hôtels haut de gamme et palaces du monde entier.

En restant au contact et à l'écoute de l'exigence de nos clients nous remettons sans cesse en question notre notion de perfection. Ce savoir-faire a été reconnu par l'attribution du prestigieux label Entreprise du Patrimoine Vivant (EPV), une distinction décerné par l'Etat mise en place pour distinguer des entreprises françaises aux savoir-faire artisanaux et industriels d'excellence.

The particularity of Horus is that it is both a craft business and an industrial company.

With its own production equipment, Horus controls its entire manufacturing process thanks in particular to its design office, its own foundries and an inhouse hydraulic and acoustic laboratory.

Its craftsmanship side comes from the expert and experienced hands of its employees, who have been perpetuating the know-how of French "haute couture" luxury for over 40 years.

This culture of excellence is partly due to the production of luxury bathroom fittings that our company has been designing since it was founded for highend hotels around the world.

By being close to our customers and listening to their requirements, we constantly challenge our notion of perfection. This know-how was recognized by the awarding of the prestigious Entreprise du Patrimoine Vivant (EPV) label, a recognition mark of the State set up to distinguish French companies with craftsmanship and industrial excellence.

Horus poursuit une exigence de qualité absolue grâce à une maîtrise et l'expertise de chaque étape de fabrication : conception interne, fonderie, composants traités dans la masse, un contrôle qualité à chaque étape de production.

Cette remise en question permanente absolue permet d'offrir à nos clients des produits manufacturés en France en proposant une large gamme de produits. Du style rétro au style transitionnel jusqu'aux formes les plus contemporaines, nos produits sont le résultat de l'ADN et du savoir-faire de notre maison française de robinetterie en respectant les exigences des différentes normes internationales. Qualité, fonctionnalité et design illustrent parfaitement l'univers de la robinetterie de luxe imaginée par Horus.

Horus is able to provide perfect quality thanks to its mastery and expertise of each step of manufacturing: in-house design, foundry, parts derived from a single block, quality control at all stages of production, hand assembly according to a solid know-how.

This constant search for perfect quality means we can offer our customers a wide range of collections of products made in France.

From retro to transitional and the most contemporary styles, our products are the result of our company's DNA and know-how, and meet the requirements of the various international standards. Quality, functionality and design perfectly illustrate the world of luxury bathroom fittings designed by Horus.

MANUEL RODRIGUEZ
Président Horus

FINITIONS PVD

PVD Finishes

CUIVRE ROSÉ
PINK COPPER

DORÉ BROSSÉ
GOLD BRUSHED

CANON DE FUSIL
METAL GUN

INOX ASI 316

Acier inoxydable austénitique, amagnétique, très résistant à la corrosion dont la poudre de départ, atomisée au gaz, a une granulométrie maximale de 22 µm. Cet acier présente une microstructure homogène à cœur et en surface permettant d'obtenir des états de surface et des usinages de qualité. Cet acier est apte aux traitements galvaniques ainsi qu'aux dépôts chimiques et physiques. Il présente une excellente résistance à la corrosion en particulier dans un milieu humide.

Austenitic, non-magnetic, highly corrosion-resistant stainless steel with gas-atomized starting powder with a maximum particle size of 22 µm. This steel has a homogeneous microstructure at its core at the surface to obtain surface conditions and machining quality. This steel is suitable for galvanic treatments as well as chemical and physical deposits. It has an excellent resistance to corrosion, particularly in a humid environment.



SOMMAIRE



EQUINOX316

Salle de bains
& Cuisine

Bathroom
& kitchen

p. 12/29



EQUINOX316

Accessoires

Accessories

p. 30/33





EQUINOX316

Salle de bains
& Cuisine

*Bathroom
& kitchen*





81 709

Mitigeur lavabo sans vidage.
Single lever basin mixer without waste.

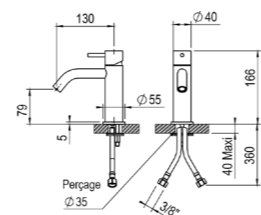

81 719

Mitigeur lavabo rehaussé sans vidage.
Single lever basin mixer extended without waste.

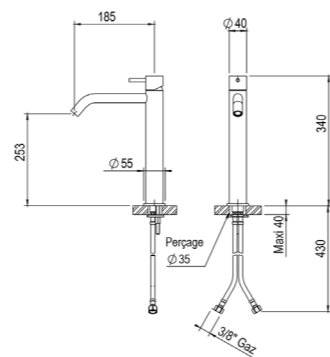

81 711

Mitigeur bidet sans vidage.
Single lever bidet without waste.

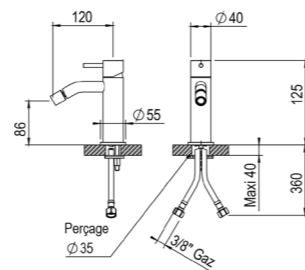

81 769

Mitigeur lavabo avec bec mobile sans vidage.
Single lever basin mixer swivel spout without waste.

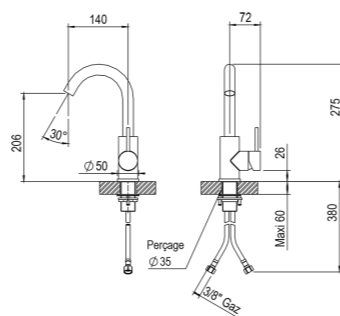

Finitions PVD

- CUIVRE ROSÉ // PINK COPPER
- DORÉ BROSSÉ // GOLD BRUSHED
- CANON DE FUSIL // METAL GUN



81 231

Robinet de lave-mains.
Handbasin mixer.

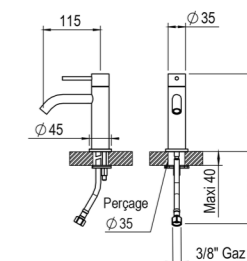

81 761

Mitigeur lavabo mural encastré.
Bec longueur 180 mm sans vidage.
Concealed basin set, spout 180mm without waste.

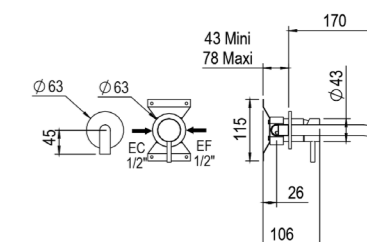

81 762

Mitigeur lavabo mural encastré.
Bec longueur 250 mm sans vidage.
Concealed basin set, spout 250mm without waste.

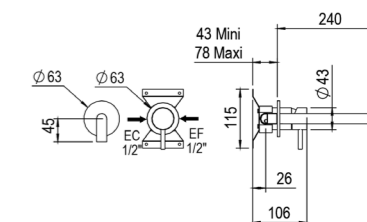

81 763

Mitigeur lavabo mural encastré.
Bec longueur 300 mm sans vidage.
Concealed basin set, spout 300mm without waste.

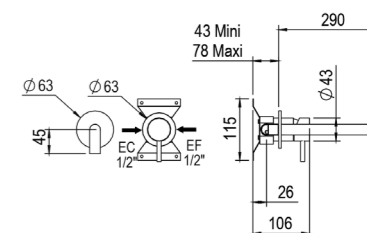

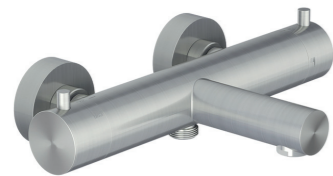

81 784

Mitigeur bain/douche thermostatique mural.
Exposed thermostatic wall bath-shower mixer.

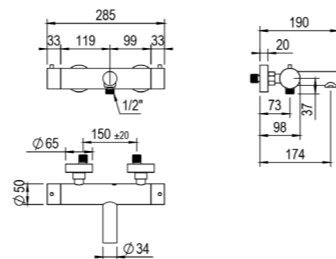

81 596

Mitigeur douche thermostatique mural.
Exposed thermostatic wall shower mixer.

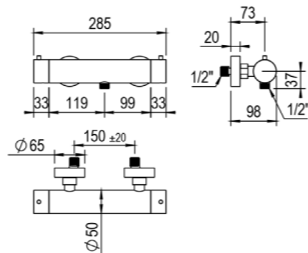

81 797

Colonne de douche mitigeur thermostatique.
Complete exposed thermostatic wall shower set.

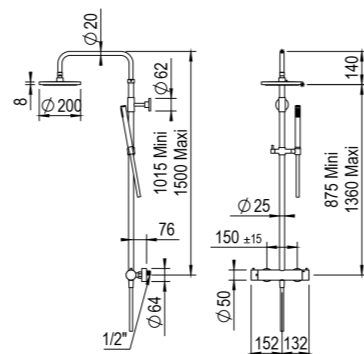

81 799

Mitigeur Bain/Douche sur colonne.
Complete exposed thermostatic wall bath-shower mixer.

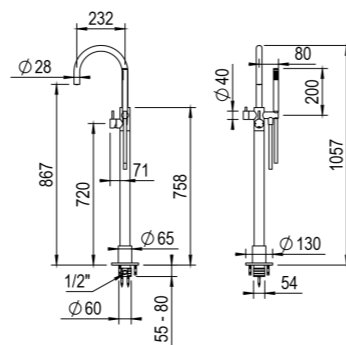

Finitions PVD

- CUIVRE ROSÉ // PINK COPPER
- DORÉ BROSSÉ // GOLD BRUSHED
- CANON DE FUSIL // METAL GUN



81 464

Mitigeur 4 trous sur gorge pour baignoire. Avec bec et douchette. + inverseur.
Deck mounted bath mixer 4 hole with flexible, spout and Hand shower.

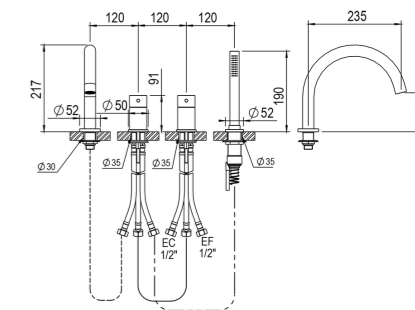

81 542

Rail de douche avec douchette et flexible design.
Wall shower set with hand shower and design flexible.

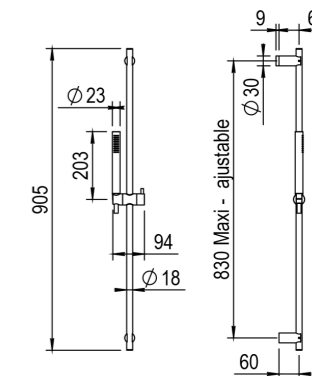

81 700

Mitigeur de douche complet à encastrer.
Concealed wall mounted manual mixing shower valve.

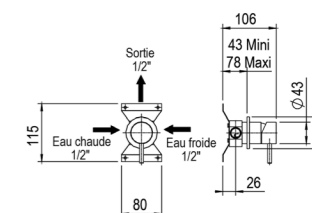

81 701

Mitigeur de douche encastré 2 sorties et inverseur.
Concealed wall mounted manual mixing shower valve with diverter 2 outlets.

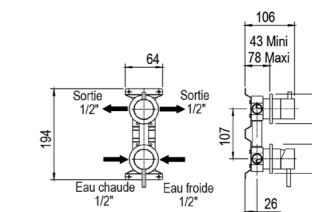



81 521

Habillage pour box mitigeur thermostatique.
Trim for thermostatic mixer.

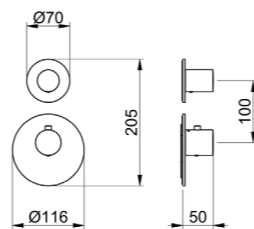

81 591

Box mitigeur thermostatique encastré 1 voie.
Insert box for thermostatic mixer with 1 outlet.

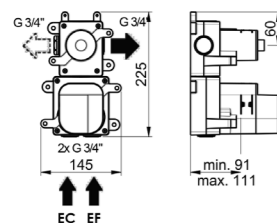

81 591 + 81 521

Mitigeur thermostatique encastré 1 sortie avec box.
High Flow concealed thermostatic mixer, with 1 stop valves.



81 523

Habillage pour box mitigeur thermostatique.
Trim for thermostatic mixer.

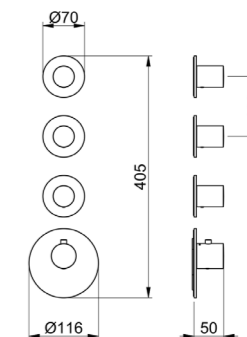

81 593

Box mitigeur thermostatique encastré 3 voies.
Insert box for thermostatic mixer with 3 outlets.

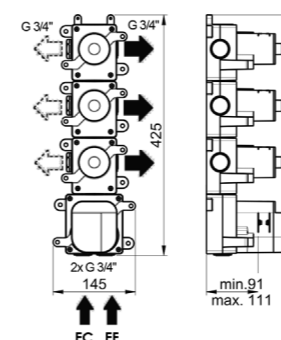

81 593 + 81 523

Mitigeur thermostatique encastré 3 sorties avec box.
High Flow concealed thermostatic mixer, with 3 stop valves.



81 522

Habillage pour box mitigeur thermostatique.
Trim for thermostatic mixer.

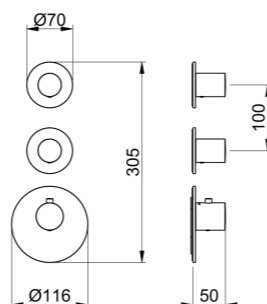

81 592

Box mitigeur thermostatique encastré 2 voies.
Insert box for thermostatic mixer with 2 outlets.

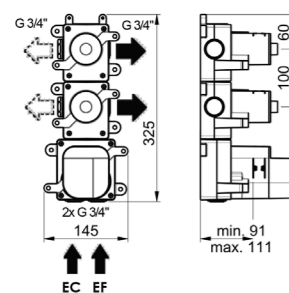

81 592 + 81 522

Mitigeur thermostatique encastré 2 sorties avec box.
High Flow concealed thermostatic mixer, with 2 stop valves.



81 524

Habillage pour box mitigeur thermostatique.
Trim for thermostatic mixer.

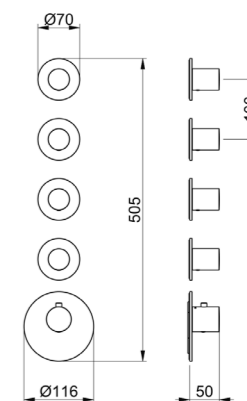

81 595

Box mitigeur thermostatique encastré 4 voies.
Insert box for thermostatic mixer with 4 outlets.

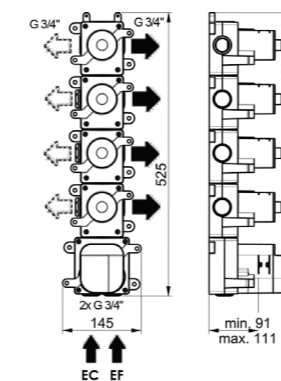

81 595 + 81 524

Mitigeur thermostatique encastré 4 sorties avec box.
High Flow concealed thermostatic mixer, with 2 stop valves.



81 525

Habillage pour box mitigeur thermostatique.
Trim for thermostatic mixer.

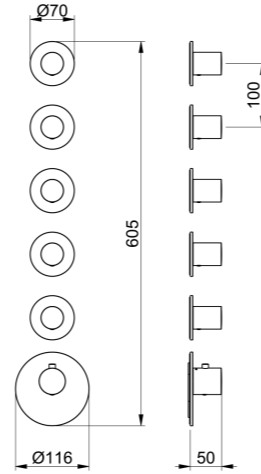

81 597

Box mitigeur thermostatique encastré 5 voies.
Insert box for thermostatic mixer with 5 outlets.

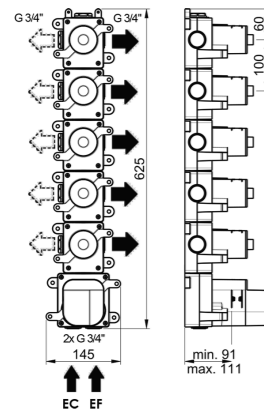

81 597 + 81 525

Mitigeur thermostatique encastré 5 sorties avec box.



81 266

Vidage à clapet couvrant fixe.
Classic Waste.

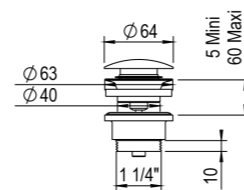

81 286

Vidage à clapet Up & Down.
POP UP Waste.

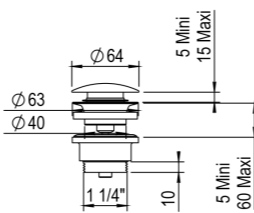

81 225

Siphon Totem.
Totem bottle trap.

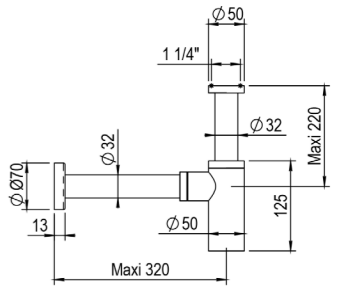

81 540

Bras de douche montage plafond longueur 200 mm.
Ceiling support for shower head, length 200 mm.

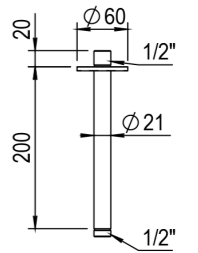

81 541

Bras de douche montage plafond longueur 300 mm.
Ceiling support for shower head, length 300 mm.

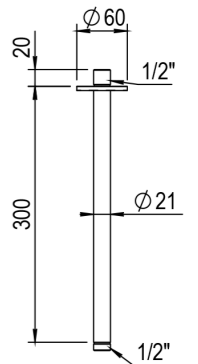

81 926

Bras de douche montage mural longueur 400 mm.
Wall-mounted shower arm, length 400mm.

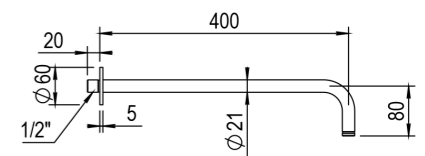



Finitions PVD

 CUIVRE ROSÉ // *PINK COPPER*  DORÉ BROSSÉ // *GOLD BRUSHED*  CANON DE FUSIL // *METAL GUN*



81 945

Pomme de douche Ø 200 mm.
Shower head ø 200mm.

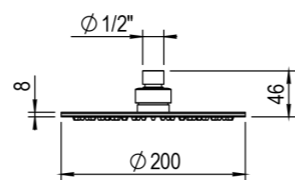

81 036

Sortie murale pour flexible
douchette.
Wall coupling.

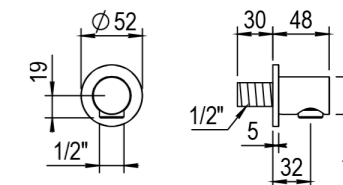

81 925

Pomme de douche Ø 300 mm.
Shower head ø 300mm.

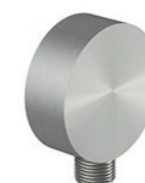
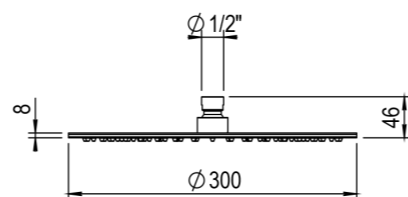

81 037

Sortie murale pour flexible
douchette.
Wall coupling.

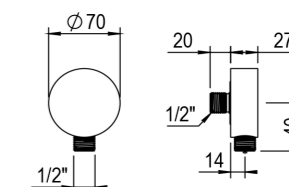

81 594

Crochet mural pour douchette.
Hand shower bracket.

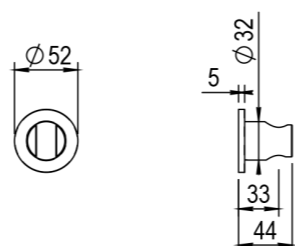

81 038

Douchette à main.
Hand Shower

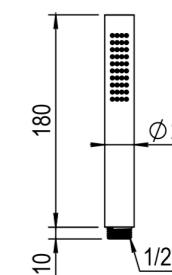

81 035

Crochet mural pour douchette
avec alimentation par le support.
*Wall coupling with hand shower
bracket.*

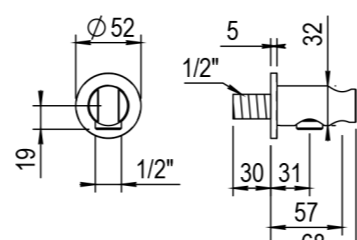

81 039

Flexible de douche noir.
Flexible hose in black.





81 704

Mitigeur de cuisine avec
douchette intégrée.
Kitchen mixer with hand spray.

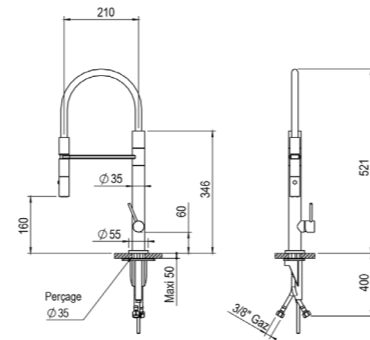

81 103

Mitigeur de cuisine.
Kitchen mixer with swivel spout.

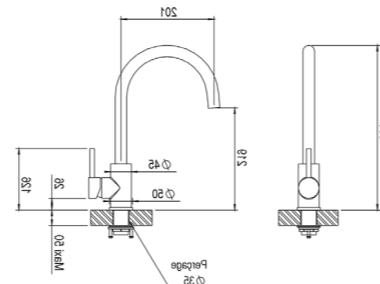

81 703

Mitigeur de cuisine bec mobile.
Kitchen mixer with swivel spout.

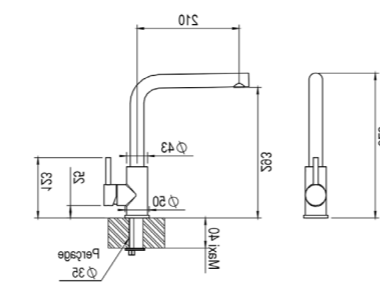

81 723

Mitigeur de cuisine avec
douchette extractible.
Kitchen mixer with Hand spray.

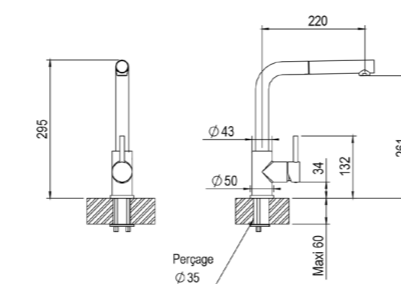



EQUINOX316

Accessoires

Accessories





81 608

Distributeur de savon liquide.
Wall-Mounted soap dispenser.

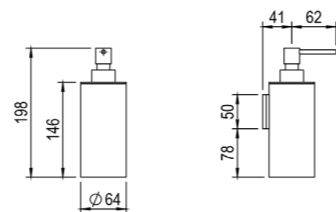

Finitions PVD

CUIVRE ROSÉ // *PINK COPPER* DORÉ BROSSÉ // *GOLD BRUSHED* CANON DE FUSIL // *METAL GUN*



81 615

Porte serviette.
Towel holder.

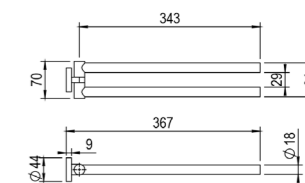

81 604

Porte verre mural.
Wall-mounted tumbler holder.



81 610

Porte serviette 300 mm.
Towel holder 300mm.

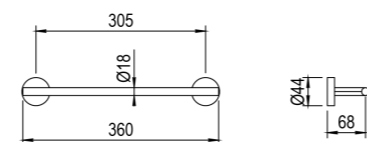

81 619

Pot à balai mural.
Wall-mounted toilet brush holder.

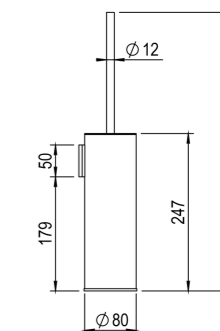

81 611

Porte serviette 600 mm.
Towel holder 600mm.

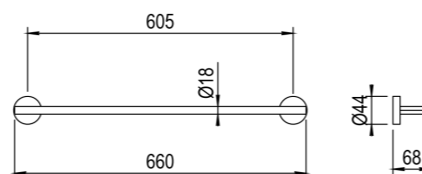

81 618

Porte papier.
Paper holder.

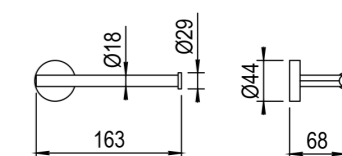

81 612

Porte serviette 800 mm.
Towel holder 800mm.

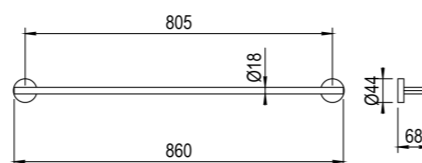

81 613

Porte manteau.
Robe hook.

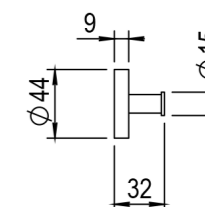

Création graphique

LCG Verdun

Impression

Novaprint Verdun



Showroom Horus

3, boulevard Voltaire - 75011 PARIS
Tél. 01.43.38.89.76

HORUS S.A.S.

Siège social & usine :
20, rue du Général Leclerc
CS 50006 - 67211 OBERNAL cedex France
Tél. : +33 (0)3.88.49.44.00
Fax : +33 (0)3.88.95.34.24

www.horusfrance.com // horus@horusfrance.com